

BOTTOM LOADING WATER DISPENSER WITH SINGLE-SERVE COFFEE MAKER

quick setup guide

- 1** Place the dispenser on the floor in the desired location in your home.

Product is intended for indoor use only.

NOTE: Do NOT plug power cord into wall outlet until instructed.



- 2** Position dispenser so the back is at least 4 inches from wall and there are at least 4 inches of clearance on both sides.

- 3** Slide drip tray into place.

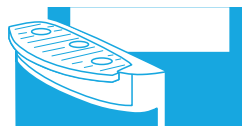

- 4** Slide brewer cup drawer into the slot until it clicks.

CAUTION: Keep fingers away from the inside of the tray as the needle is very sharp.

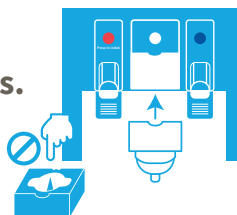

- 5** Clean probe with a damp cloth and dish soap.

Visit PrimoWater.com for detailed cleaning instructions.

Place probe assembly on hanger inside door to keep it clean.

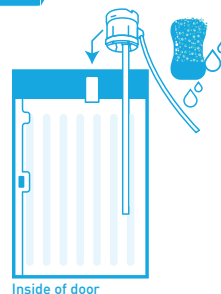

- 6** Insert probe assembly into bottle.

Press firmly to secure assembly over bottle opening. For 3-gallon bottles, squeeze the tabs on the top of the probe assembly to separate the probe cap from the collar and press the collar securely over the bottle opening.

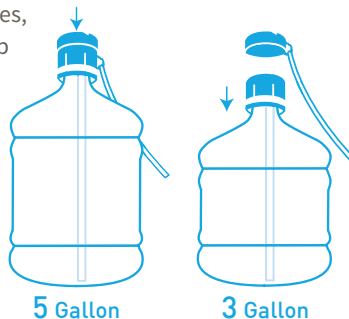

5 Gallon

3 Gallon

- 7** Slide bottle inside the cabinet and close cabinet door.

NOTE: Water will not pump from bottle unless door is fully closed.

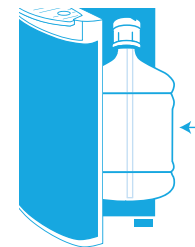

- 8** Plug dispenser into a ground fault circuit interrupting (GFCI) outlet.

You will hear the dispenser begin to pump water to fill the internal hot and cold reservoirs.



- 9** Turn on desired functions by flipping the switches on the back of the dispenser to the ON position.

Blue – chills water
Green – night light
Red – heats water

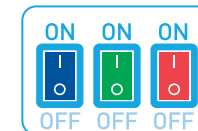

- 10** Once the dispenser has stopped filling the internal reservoirs, dispense and dispose at least 1 quart (approximately 2 pint glasses) of water from both the hot and cold spouts.



- 11** Your water will be ready to dispense fully chilled in approximately 1 hour or piping-hot in approximately 12 minutes.



To learn more, visit water.com